



REFLECTIONS

NORTHERN TIER NATIONAL HIGH ADVENTURE



Alumni Asked To Fund Lodge Remodeling

At the February 13 mid-winter meeting of the Northern Tier National High Adventure Committee, Duluth architect and committee member **Don Melander** unveiled the Physical Facilities Plan associated with the previously approved 1993-97 Strategic Plan. The Facilities Plan detailed an ambitious program of capital improvements including: (1) completing the

Lodge remodeling project, (2) construction of first-night crew housing, (3) construction and remodeling of the administrative officers and staff center, (4) constructing a new outfitting building, and (5) renovating and expanding the Trading Post and Dining Hall. The plan was favorably received by the National BSA executives in attendance, and the Commit-

tee voted to move forward and to launch a major fund-raising campaign in order to match the much needed national BSA capital with private donations.

The National Council has already approved funding for the first-night crew housing and construction will begin this spring and will be completed prior to the 1993 season. As reported in the Winter 1992

issue of *Reflections*, the Lodge project has been partially completed with BSA funds, and the Committee has asked the Sommers Alumni Association to raise the incremental funding necessary for completion. The SAA Executive Committee (all in attendance) agreed, and commissioned this Special Issue of *Reflections* to kick off the campaign.

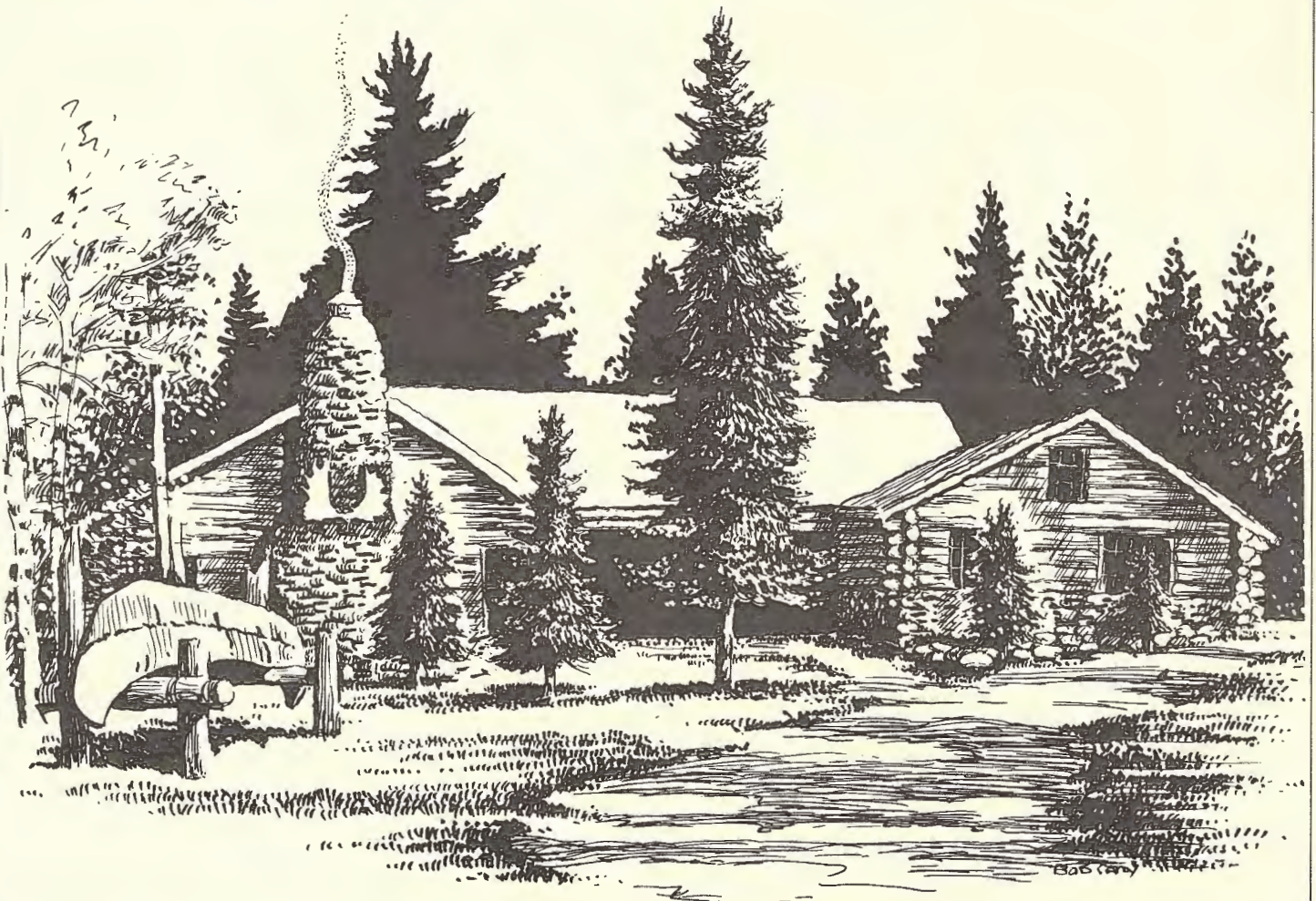

A Project Worthy of Your Support

More than any other physical aspect of the Base, the Charles L. Sommers Lodge, built in 1941-42, is the "glue" that binds generations of Alumni together. In that respect, the Directors felt that it was a project worthy of your support, and are asking you to make a difference in helping us raise the \$50,000 it will take to complete the renovation. Our plans call for moving very quickly so that work can be completed prior to our September 2-5 Alumni Reunion.

To recap the project—The renovation has been very extensive and has involved refinishing the building's exterior, removing all of the non-log partition walls, replacing the concrete floor everywhere except in the **Fireplace Room**, adding heating coils in the new floor, replacing most of the electrical wiring and service panel, installing new wainscoting, tuckpointing all of the cement work and building a new curved stairway from the **Log Stair Room** to the **Hedrick Library**.

Yet to complete—All interior finishes, cleaning and sealing of concrete floors, exterior log repairs, fireplace repair (including the addition of a custom built insert with heatilator), and a complete reconfiguration of interior lighting. Winterizing the building for year-round use will require a new insulated roof, winterizing the windows with storm panels, and adding a hot water heating system.

The Lodge's future use—The Lodge will play a major role in the Base's program activities, and will be the center of each crew's on-base trip planning training. As depicted in the schematic diagram, the **Fireplace Room** will serve as a gathering room for "Campfires and Rendezvous" during the summer, and as a first-rate meeting/training room for the remainder of the year. The **Log**

Stair Room will house an interpretive center with various maps, memorabilia and displays. The **Hedrick Library** will house the Base's fine collection of books, journals, and other canoe country documents. It should be noted that the **Fireplace Room** and the **Log Stair Room** have not been "officially" named, and are so identified for descriptive purposes only.

Dallas Businessman Jumpstarts Fundraising

Dallas businessman and SAA Charter Life Member, **Jim Sowell** ('65-'69) has given our campaign a major boost by pledging up to \$10,000 in a one-for-two match of individual member contributions. This no doubt inspired **Henry Bradlich** (50's-80's) to be the very first alumnus to send a check for \$500—possibly figuring that he finally found a way to get some

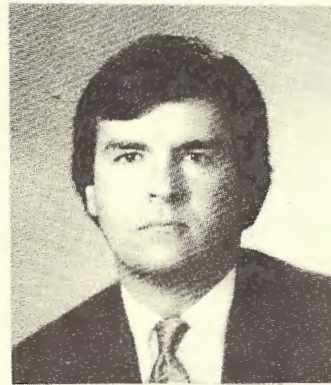

Jim Sowell

work out of Jim! Seriously, the SAA is deeply appreciative of Jim's generosity, and are most pleased that he has chosen to help in this major way. He lived for a number of summers in the "loft" (**Hedrick Library**) and his antics during those years provided many of us with enduring, warm and pleasant memories. Thanks Jim!

News Briefs

In early June, the next regular issue of *Reflections* will be coming your way. It will contain all of the details you'll need to register for our September 2-5 Alumni Reunion. In addition, we'll report on the "USFS Group Size Issue" in which over 500 of you sent letters to the Forest Supervisor telling her (at a rate of 150 to 1) that you did not favor the proposed reductions. All of our regular features will be there as well.

Acknowledging Your Contribution

No fund-raising campaign would be complete without some form of acknowledgment. All contributors will be recognized via a plaque to be

displayed in the Lodge (unless they indicate otherwise). In addition, each will receive an 8x10 print of the Lodge by author/outdoorsman/artist

Bob Cary. While gifts of any size are needed, persons making the following donations will also receive:

Amount Contributed

\$100-\$249

\$250-\$499

\$500-\$999

\$1000+

Recognition

50th Anniversary Lodge Mug

Signed copy of Bob Cary's *Root Beer Lady*, along with signed print (Cary) of Dorothy Molter

Video of "Joe Seliga—Canoe Maker," plus signed (Cary) print of Joe

Signed print of Minnesota Timberwolf by photographer Jim Brandenburg

Opportunities also exist for recognition through memorial gifts. Please contact Dave Hyink (206) 863-6406 for details.

Lodge Renovation Plans

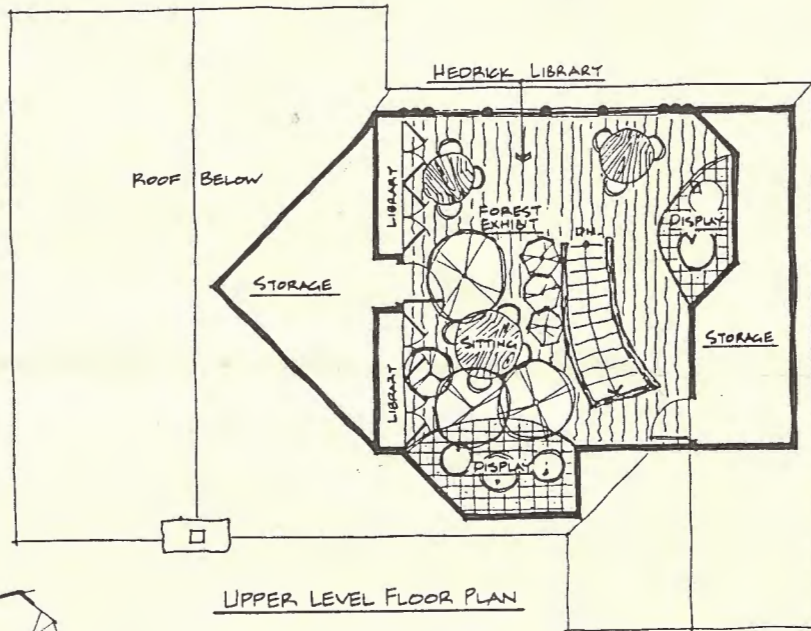

UPPER LEVEL FLOOR PLAN

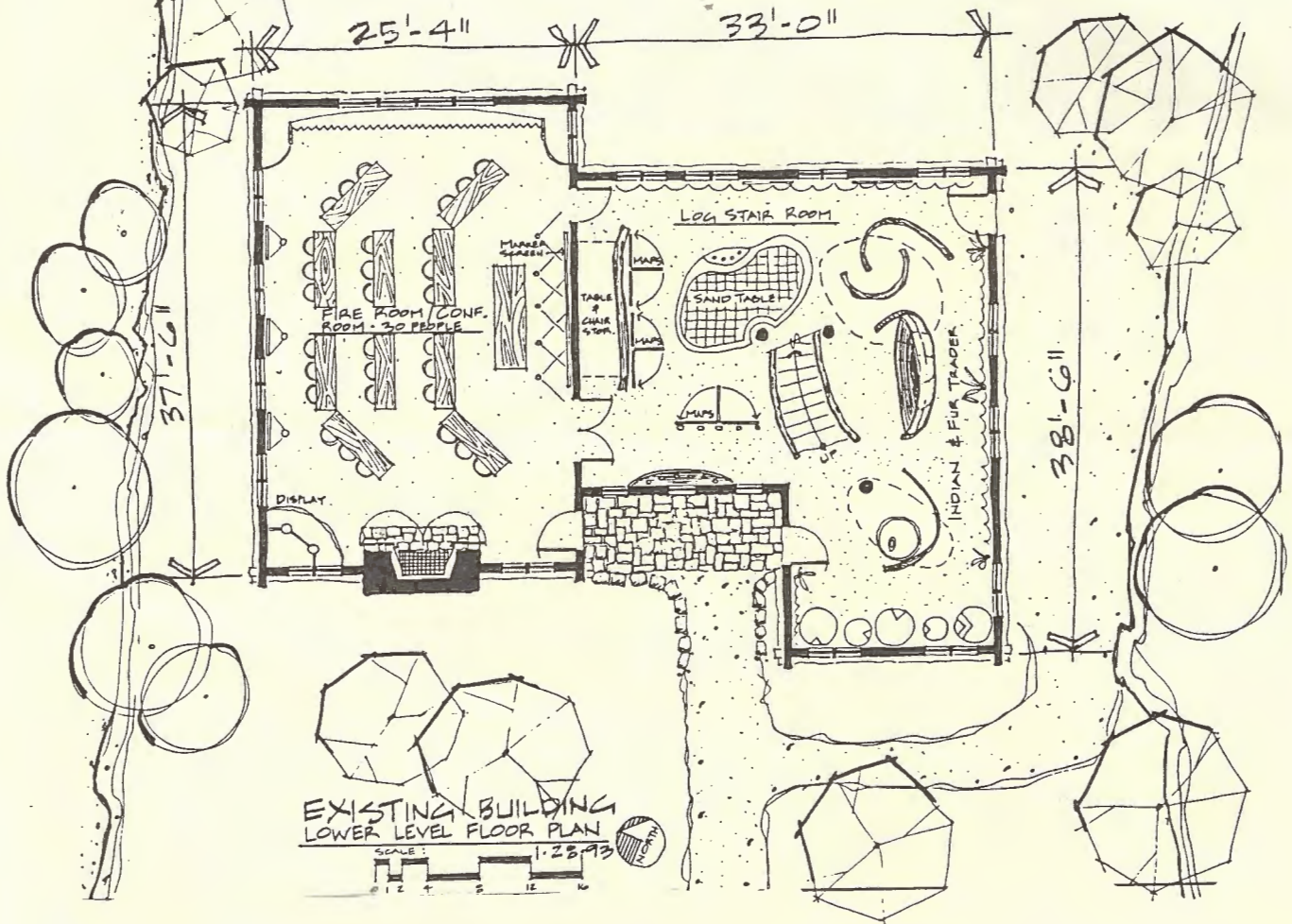

EXISTING BUILDING LOWER LEVEL FLOOR PLAN

SCALE: 1" = 28'-93"



Artist Unknown (Crew Advisor)

**SOMMERS ALUMNI ASSOCIATION
P.O. BOX 428
ELY, MN 55731**



NONPROFIT
U.S. POSTAGE
PAID
Ely, MN
PERMIT No. 102

SPECIAL LODGE REMODELING ISSUE



74114-3222 01

